

SUBMITTAL DATA SHEET

No-Lead Pex Valves & Accessories No-Lead Pex Stub Out Elbow - 2590

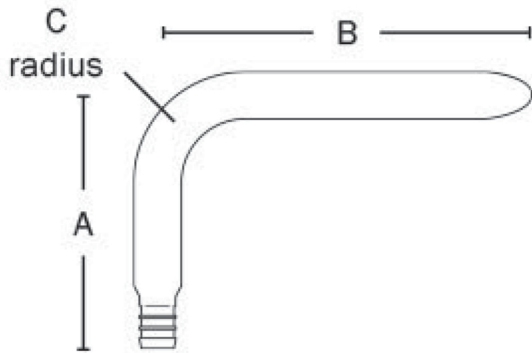

Dimensions

| Connection | CTS | Dim A | Dim B | Dim C |
|------------|------|--------|-------|--------|
| 1/2" | 1/2" | 3 1/2" | 6" | 1 1/4" |
| 1/2" | 1/2" | 3 1/2" | 8" | 1 1/4" |
| 3/4" | 3/4" | 4 1/2" | 8" | 1 1/4" |

Finishing Tubing Runs

After properly running and fastening the PEX tube, it's time to terminate the run into a finished area of the house (through a floor or a wall). Although there are some situations where it makes sense to crimp the tube directly to a valve or fixture (basement laundry or sink), it is best use a copper stub out due to their rigidity and resistance to bangs and bumps that could cause leaks.

Step 1

Crimp PEX tube to a straight PEX stub out or a stub out elbow depending on whether you need to make a turn as you come through the wall. Make sure stub out is properly secured.

YOU'LL NEED

- Crimp tool
- Crimp rings
- Plastic Hangers

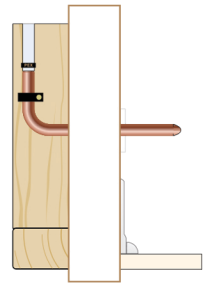

Step 2

Cut the spun-closed end off of the stub out, then deburr and clean the outside of the tube with sand cloth.

YOU'LL NEED

- Copper cutting/deburring tool
- Sand Cloth

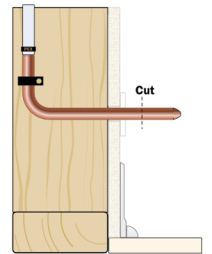

Step 3

Using two wrenches, compress the stop valve onto the copper tube. Be careful not to over-tighten the joint.

YOU'LL NEED

- Wrenches
- 5/8" supply stop valve

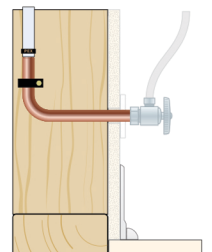

SUBMITTAL INFORMATION

- Sizes: 1/2" x 3 1/2" x 6"
1/2" x 3 1/2" x 8"
3/4" x 4 1/2" x 8"
- Spun closed ends
- Accepts sweat, push fittings, & compression valves
- Type L Copper
- One piece copper

NO-LEAD: The weighted average of the wetted surface of this no-lead product contacted by consumable water contains less than one quarter of one percent (0.25%) lead.



A.Y. McDonald Mfg. Co.
P.O. Box 508
Dubuque, IA 52004-0508

Toll Free: 1-800-292-2737
Fax: 1-800-832-9296
Hours: 7:00 a.m. - 5:00 p.m., CST

sales@aymcdonald.com
www.aymcdonald.com

A.Y. McDonald considers the information on this assembly drawing correct when published. Item and option availability, including specifications, are subject to change without notice.

Submitted by: