

Push Connect® FIP Water Heater Connector with Ball Valve

Product Specifications



FEATURES & PERFORMANCE

- Compatible with Copper, CPVC & PEX
- Removable and Reusable
- Push to Connect
- Full Flow
- Maximum Working Pressure: 200 PSI
- Decomposition Temperature: 482° F
- Service Temperature: 248° F
- Flash Point: 572° F
- Burst Pressure: 800 PSI
- Approved for Plumbing and Heating Applications

NOTE: When using PEX, a tube stiffener should be inserted into the PEX tubing end prior to insertion into the fitting.

MATERIALS & SPECIFICATIONS

#	Component	Material
1	Rubber Hose	EPDM 80 Perox
2	Ferrule	Stainless Steel
3	Hose Braiding	Stainless Steel
4	Fitting Head	Lead Free Brass
5	O-Ring	EPDM 70 Perox
6	Push Release	POM
7	Grip Ring	Stainless Steel
8	Seat Ring	POM
9	Swivel Assembly	Chrome Plated
10	Plastic Washer	ABS Plastic

FORCES FOR MECHANICAL SEPARATION TEST

Nominal Size		Longitudinal (Pull) Test	
Inches	mm	Lbf	N
1/2	13	150	667
3/4	19	275	1223.2

✓ To Submit	Part #	Size
	MLUFX18BVLF	18" Hose, 3/4" Valve x 3/4" FIP
	MLUFX18BVLF-S	18" Hose, 3/4" Valve w/ Stiffener x 3/4" FIP

Warranty

See warranty information for more details.

All dimensions listed are nominal. MAINLINE® reserves the right to make product and material changes at any time without notice.

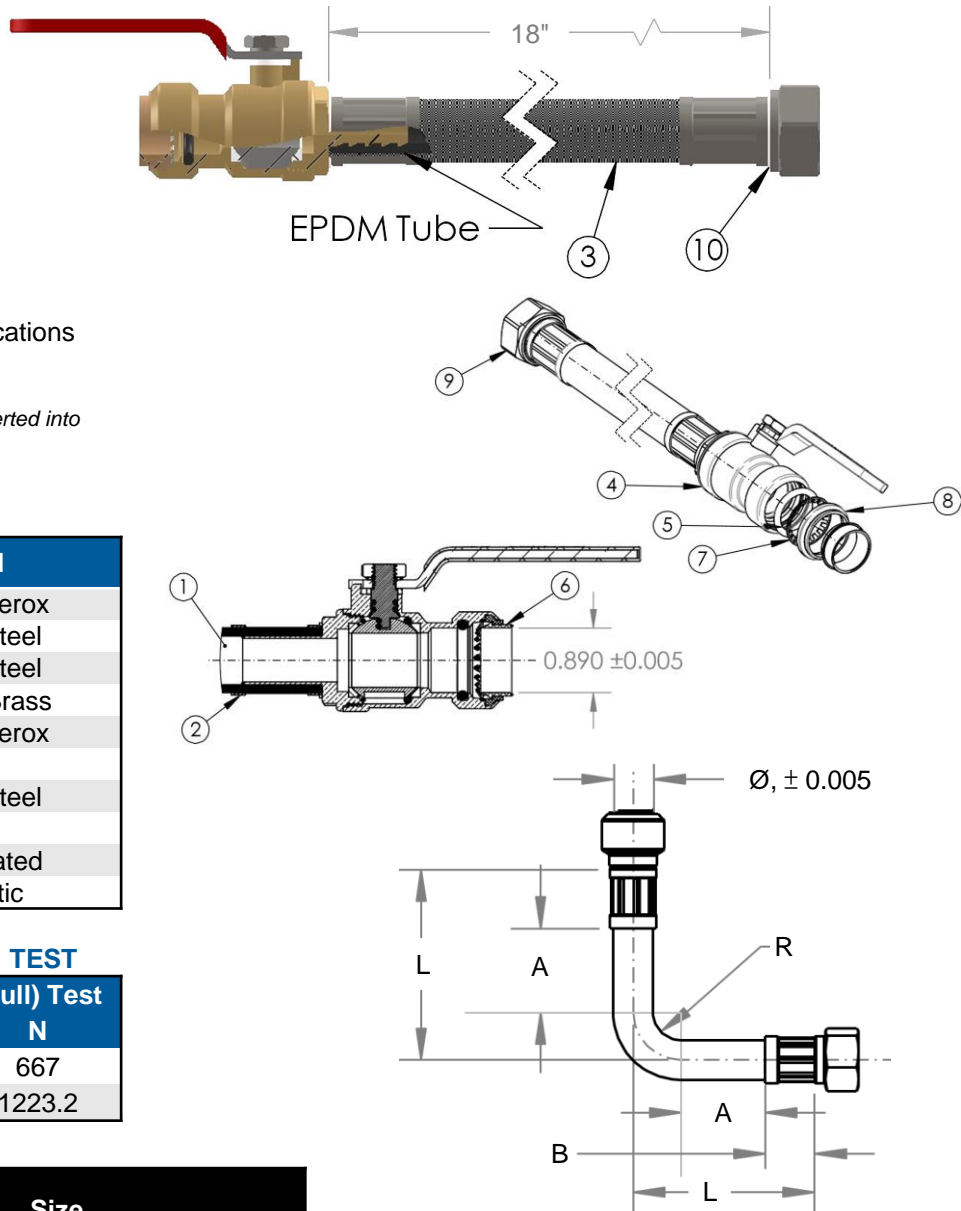

BENDING RADIUS (in)

Ø	R	A	B	L (@ 90°)
3/4"	2.17	2.17	1.38	1.59



*≤ .25% Pb

Contact your sales representative for more information or visit our website at mainlinecollection.com