



Plastic Commercial Elongated Toilet Seat

Product Specifications

Description

Closed front with cover, elongated, heavy-duty, injection molded solid plastic toilet seat. Features four, molded-in bumpers, check hinges with non-corrosive 300 Series stainless steel posts, pintles and hardware. This seat complies with American National Standard Z124.5 Toilet, (Water Closet), Seats as a class Commercial Heavy Duty.

Model: ML7600TT

Specifications	
Size:	Elongated
Weight:	4.2 lbs
Color:	White (000)
Material:	Plastic
Style:	Closed Front with Cover
Bumpers:	Four
Hinges:	Plastic with 300 Series Stainless Steel Posts and Pintles
Fastening System:	300 Series Stainless Steel Hardware



PLASTIC HINGES WITH STAINLESS STEEL POSTS AND PINTLES



300 SERIES STAINLESS STEEL HARDWARE

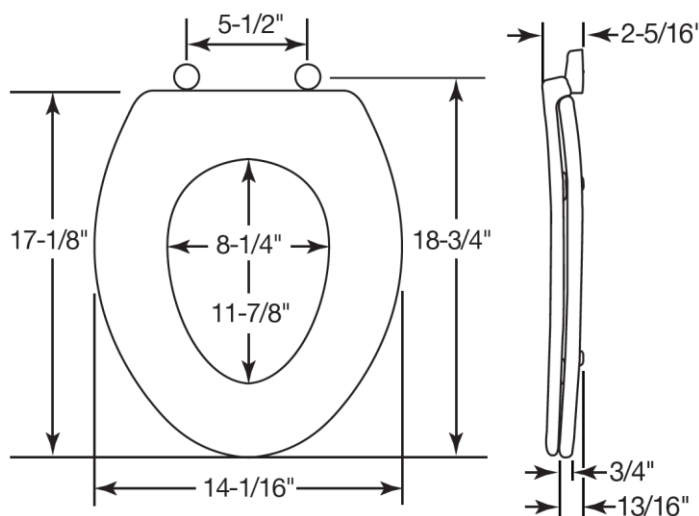

Warranty

See warranty information for more details.

All dimensions listed are nominal. MAINLINE® reserves the right to make product and material changes at any time without notice.



Complies with IAPMO/ANSI Z124.5 Performance Standards Heavy-Duty Commercial



Contact your sales representative for more information or visit our website at mainlinecollection.com