

PIAZZA

INSTALLATION

One-Piece Concealed Toilet with Toilet Seat



INCLUDED PARTS

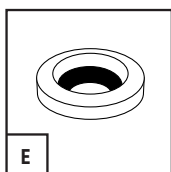
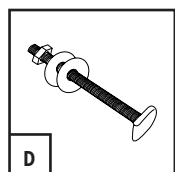
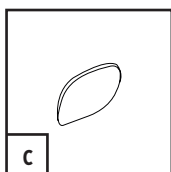
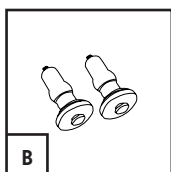
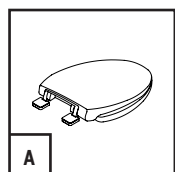

- | | |
|---------------------------------|----|
| A Plastic Toilet Seat | x1 |
| B Toilet Seat Bolts | x2 |
| C Plastic Oval Side Caps | x2 |
| D Floor Bolts | x2 |
| E Wax Ring | x1 |

INSTALLATION TIPS

Luxart suggests using a locally licensed plumber for installation.

Installation

NOTE REGARDING WATER SUPPLY: Before installation ensure that the shut-off valve is greater than 7½" from the center of the drain to the center of the shut-off valve and less than or equal to 7" from the floor (**FIGURE 1**).

Note: This is a true 12" rough-in from finished wall to center of the drain (no less than 12").

1. Make sure the water supply valve is shut off before installation.
2. Remove old floor bolts from floor flange. Clean any old wax, putty, etc. from base area.
3. Install new floor bolts (D) into floor flange using plastic washers to secure bolts. Adjust the floor bolts to ensure they are parallel to the wall (**FIGURE 2**).
4. Connect water supply (not included) line to the tank fitting only (**FIGURE 3**).
5. Turn the toilet sideways onto a soft surface to avoid scratches on the finish. Place a new wax ring (E) around the waste flange of the toilet bowl (**FIGURE 4**).

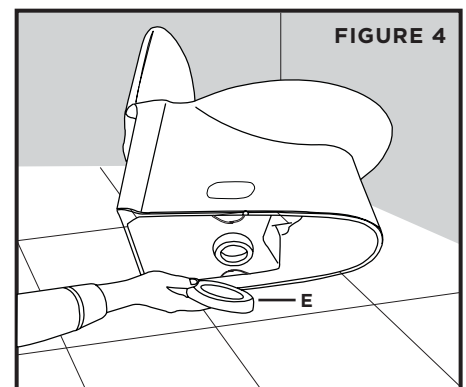
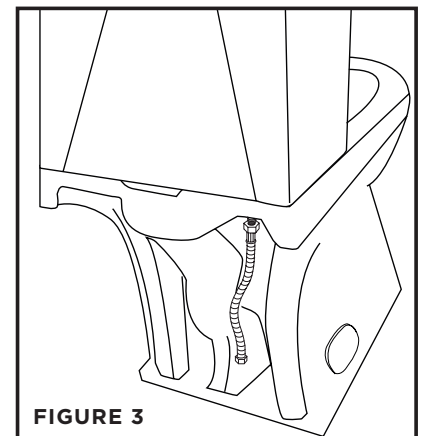
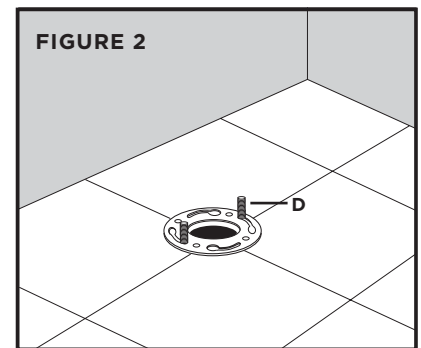
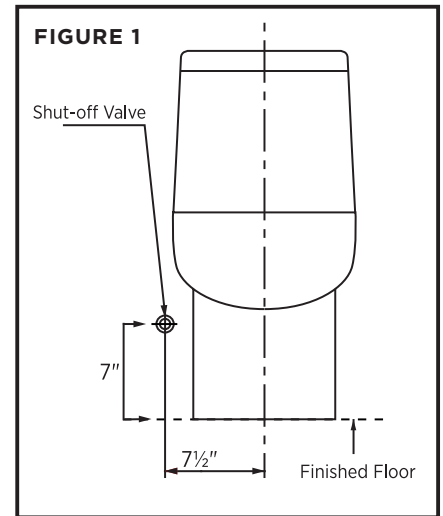

Installation

- Lower the toilet onto the floor bolts, so the floor bolts project through the mounting holes in the base of the toilet (**FIGURE 5**). Using a rocking motion, press the bowl down to position the toilet onto the flange and create a seal with the wax ring.

Warning: This product is heavy. two people are recommended for safe installation.

- Install metal washers and nuts onto the floor bolts (**FIGURE 6**). Tighten the bolts alternately until toilet is firmly seated on the floor.

Caution: Do not overtighten nuts, severe damage may occur.

- Attach the plastic oval side caps on each side of the bowl.
- Connect water supply line to shutoff valve. Tighten securely.
- Turn on supply valve and allow tank to fill until float rises to shutoff position.
- Check for leakage at fittings, tighten or correct as needed.

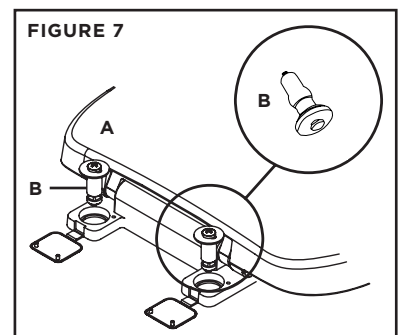
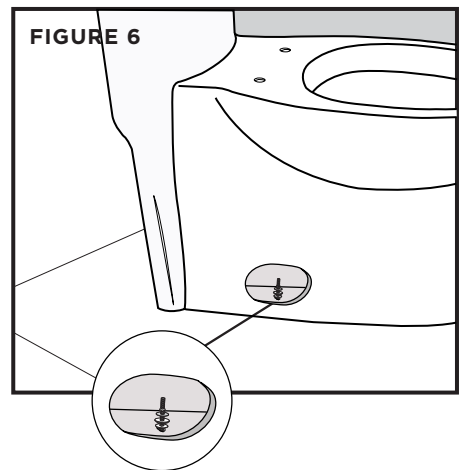
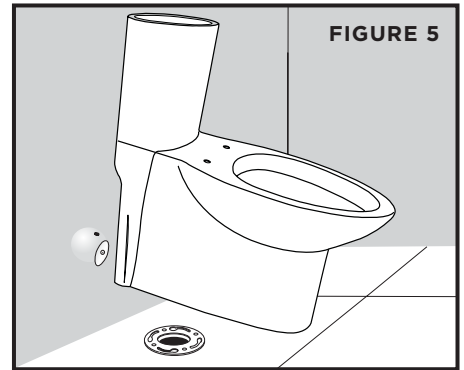

Toilet Seat Installation

- Place the toilet seat (A) on top of the bowl and then insert the provided seat bolts (B) into the holes of the toilet seat and bowl (**FIGURE 7**).
- Align the toilet seat to the top rim of the toilet bowl.
- Use a screwdriver to firmly tighten both seat bolts down to the bowl (**FIGURE 8**).
- Close the decorative caps down over the bolts.

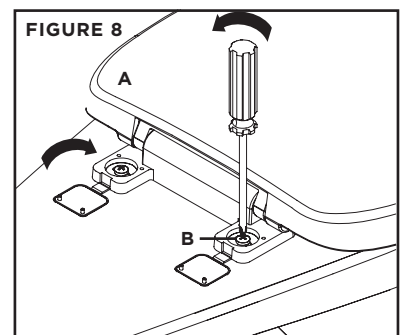



Beauty in every detail.

Luxart® products will be covered by Foremost Groups, Inc.'s limited warranty. It is as follows: Foremost warrants its products to be free from defects in material or workmanship (Vitreous China) and 1 year (Parts and Fittings) from the date of purchase original purchaser.

If inspection of this plumbing product, within 5 years (china product) or 1 year fittings) after its initial purchase, confirms that it is defective in materials Foremost will repair or at its option, exchange the product for a similar model. Foremost provides no warranties or guarantees beyond those in this Limited Foremost

This limited warranty applies only to the original purchaser and installation de- installation and re-installation and transportation costs or charges incidental to warranty services are to be borne by the owner. In no event will Foremost® be liable or replacement of any installation materials, including but not limited to, tiles, marble etc. Foremost will not be responsible for and this warranty does not cover and specifically excludes any liability to the purchaser or any third party for consequential or incidental damages, all which are hereby expressly disclaimed, or the extension beyond the duration any implied warranties, including those of merchantability or fitness for

This warranty does not apply to local building code compliance. Since local building considerably, the purchaser of this product should check with a local building contractor to ensure local code compliance before installation.

Foremost shall not be responsible or liable for any failure or damage to its toilet tank trim, plumbing fittings, or china products caused by the use of either chloramines concentration of chlorine, lime/iron sediments and/or other minerals not removed from public water during the treatment of public water supplies or caused by toilet tank type cleaners containing chlorine, calcium hypochlorite, and /or other chemicals.

This warranty is void if the product has been moved from its initial place been subjected to faulty maintenance, abuse, misuse, accident, or other not installed in accordance with Foremost's instructions; or if it has manner inconsistent with the product as shipped by Foremost.

NOTE: Some states or provinces do not allow the limitations on an implied warranty, and some states/provinces do not allow exclusions or limitations regarding incidental damages, so the above limitations may not apply to you. This warranty gives rights, and you may have other rights, which vary from state to state or person is authorized to change, add to, or creates any warranty or obligation forth herein.

**Effective July 1, 2023, due to an update in California law, the start date for product warranties will now be aligned with the date of delivery of the product. This change is for all Luxart products purchased on or after July 1, 2023 by California consumers. (California Legislative Information AB-2912)*