

Flush Valve/Tank Lever Installation Instructions

Work Preparation: Remove the inoperative tank fittings and carefully clean the water cistern/tank. Make sure all debris has been removed prior to installing new tank fitting

Installation Drawing



Instructions

- 1). Please read carefully the following installation instructions in order to avoid component damage or injury to the installer.
- 2). The instructions have been composed based in the latest product specifications. We reserve the right to make modifications to the packaging and specifications without providing prior notification.
- 3). When installing the fill valve, the critical level on the fill valve (identified on the valve marked "CL") should be at least 1" (25.4mm) above the top of the overflow pipe of the flush valve. This is a plumbing code.
- 4). We shall not be responsible for failures that are contributed to the use of parts other than those specified.
- 5). Water Temperature: 2°C to 45°C
- 6). Water Pressure Range: 0.02Mpa (0.2 Bar) to 0.8Mpa (8 Bar)



Warning

DO NOT USE OR DROP ANY CHLORINE OR ANY CHEMICAL RELATED COMPONENTS. USE OF SUCH PRODUCTS WILL RESULT IN DAMAGE TO TANK COMPONENTS AND MAY CAUSE FLOODING AND PROPERTY DAMAGE AND VOID WARRANTY. DO NOT OVERTIGHTEN NUTS, OR TANK/BOWL MAY CRACK.

Installation of flush valve for 1-piece toilet

LXFLUSH200
LXFLAP100

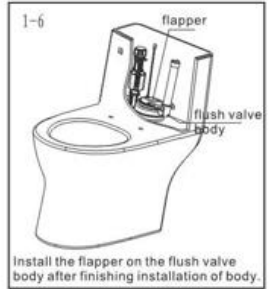
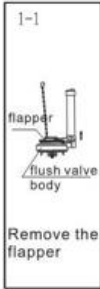

Installation of flush valve for 2-piece toilet

LXFLUSH100
MLFLUSH100
MLFLUSH400
MLFLUSH500
MLFLAP100

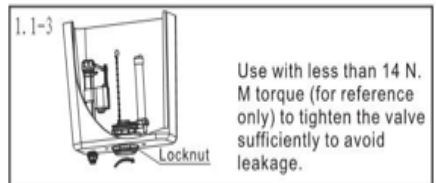
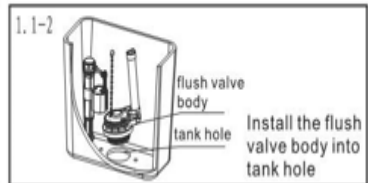
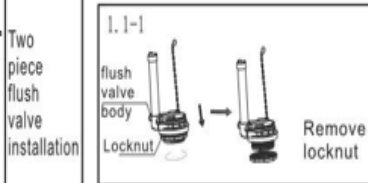

Installation of tank lever and refill tube

LXLEVER100
MLLEVER100/200/
300/400/500/600/
700/800

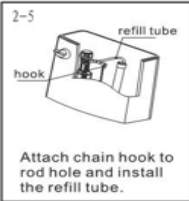
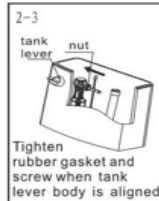
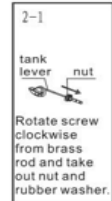

Adjustment of chain length

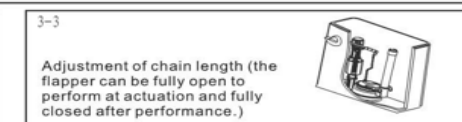
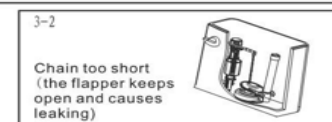
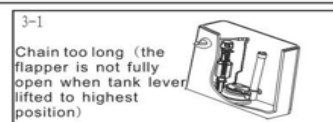

Troubleshooting

Issue	Cause	Resolution
Leaking	<ol style="list-style-type: none"> 1. Flush valve nut not tightly screwed. 2. Flush valve incorrectly installed. 3. Chain too short and water seal not well fit on flush valve. 4. Flapper not fit on valve body. 	<ol style="list-style-type: none"> 1. Screw the nut. 2. Re - install according to installation procedures 3. Re - adjust chain length. (reference drawing 3-3) 4. Re - install flapper.
Little or no flush	Chain is too long	Adjust chain length (reference drawing 3-3)
Not shut - off	The refill tube wasn't installed properly. (reference drawing 2-6)	Adjust refill tube, make sure tube is above water level. (reference drawing 2-7).

If you have any questions or concerns, please contact us at mlcustomerservice@hajoca.com