

# Bidet Seat

**OWNER'S MANUAL**  
MANUALLY- OPERATED

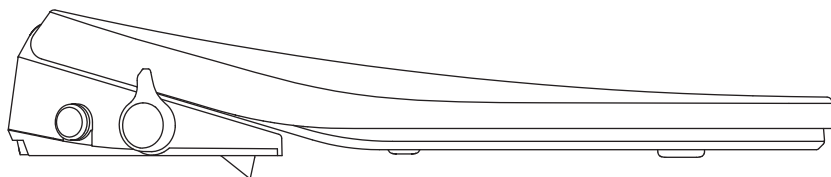

# Contents

---

- Thank you for you purchasing our manually-operated Bidet toilet seat. Please read the manual carefully and use this product correctly.
- Please keep this manual in a convenient place.

Safety notes .....	<b>2</b>
Product Information .....	<b>3</b>
Product Dimensions .....	<b>3</b>
Component Description .....	<b>4</b>

**Before use**

Installation Instructions.....	<b>5</b>
Function Introduction .....	<b>7</b>

**Installation and use**

Product Technical Specification .....	<b>8</b>
Troubleshooting.....	<b>8</b>
Cleaning and Maintenance .....	<b>9</b>
Warranty Card .....	<b>10</b>

**Other**

# Safety Notes

Read the safety instructions carefully before use to ensure proper use of this product.  
Note the following warnings relevant to safety.

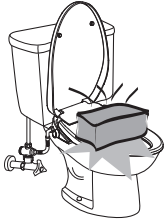

Do not place heavy objects on the toilet seat or cover.

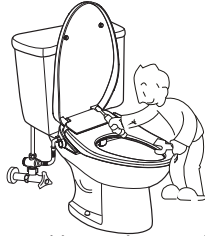
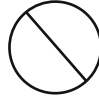

Do not disassemble, repair or modify this product without authorization.

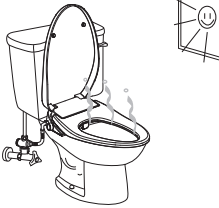
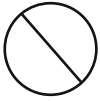

Do not place this product in direct sunlight.

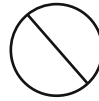

Do not bend or twist the water supply hose.

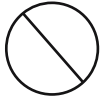

Do not lean against the toilet lid when in use.

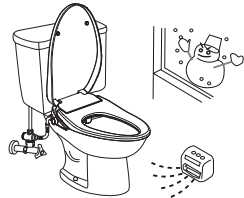
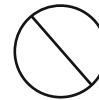

The room temperature of toilet should always be above 32°F

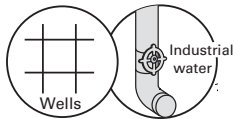
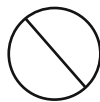

Do not connect to any substandard water pipe.



Clean with diluted mild dish detergent and avoid benzene, paint thinner, or nylon brush usage powdered detergents.

# Product Information

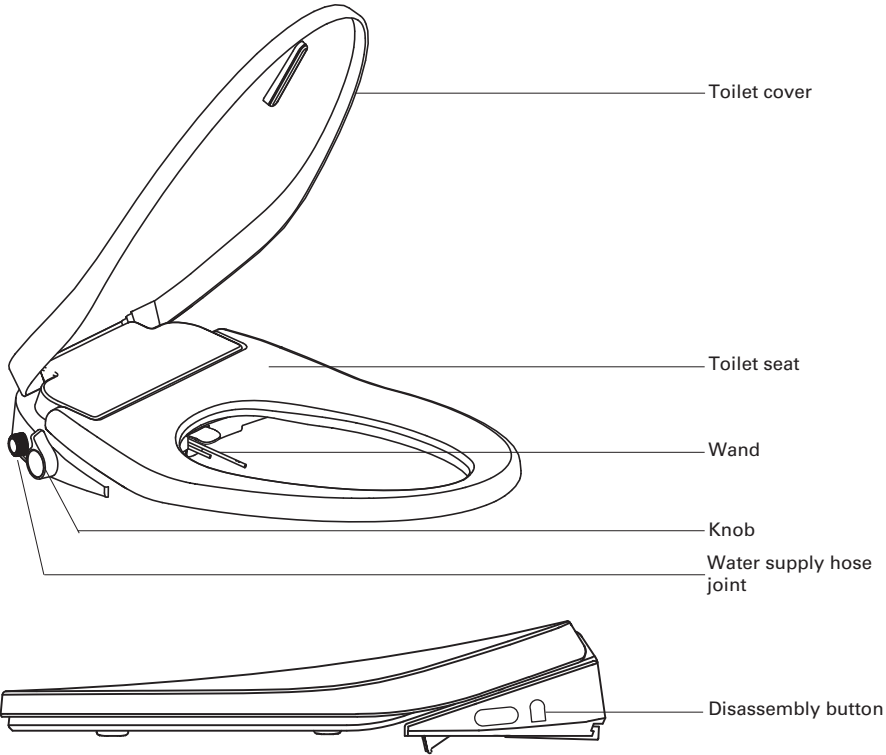

## ● Product dimensions

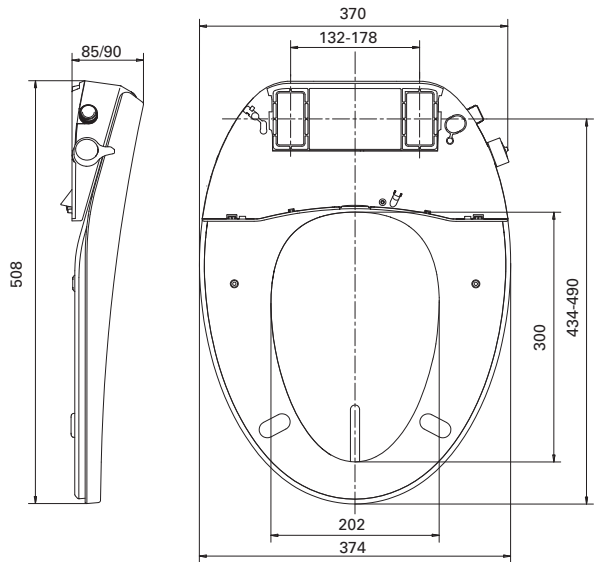

size: mm

# Component Description

---

1. Bidet Seat

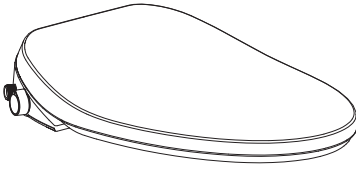

2. Installation template

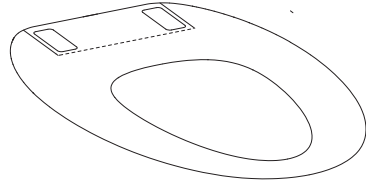

3. Hardware



Connecting bolt (2)



Adjustable bracket (2)



Plastic TAB(2)

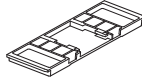

Mounting plate



Expansion bolt(2)

4. T-valve connector

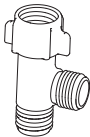

5. Water supply line hose



Filter screen

6. User manual

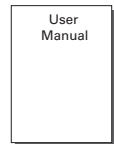

# Installation Instructions

## •Tools you will need



Phillips head screwdriver

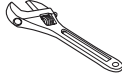

Adjustable pipe wrench



Bucket and rag

## •Before installation

- 1.For maximum effectiveness, water pressure range should be 0.1-0.75MPa.
- 2.Stop valves should be located close to the location where this product is installed and disassembled.
- 3.Please use the braided hose that comes with the product to prevent water leakage.
- 4.When installing the braided hose,avoid letting the black gasket fall out.

## • Installation Procedure

- 1.Looseen the connecting nut and remove the old toilet seat.



- 2.Place the mounting template on the ceramic as shown. Align it with the rim of toilet.

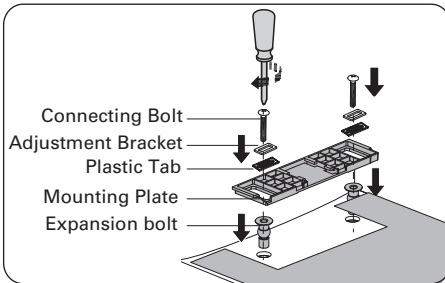
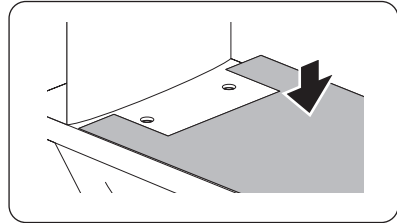

3.
  - a. Insert the expansion bolt into ceramic hole;
  - b. Place mounting plate in notch on template;
  - c. Place adjustable bracket and plastic tab in mounting plate;
  - d. Align connecting bolt with expansion bolt hole , and tighten up;

- 4 .Slightly push the cover into fixing plate until you hear a "click" , indicating that the cover has been installed in place.

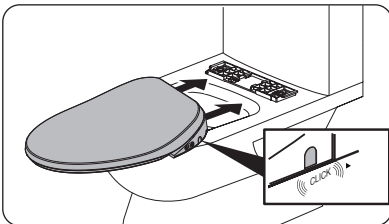

- 5.Close the stop valve

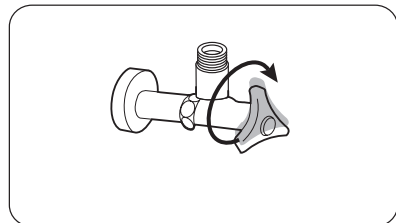

# Installation Instructions cont.

## 7. Install supply line

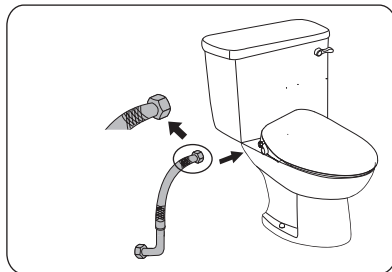

① When the toilet is similar to the figure above, we suggest connecting the straight end of the hose to the cover

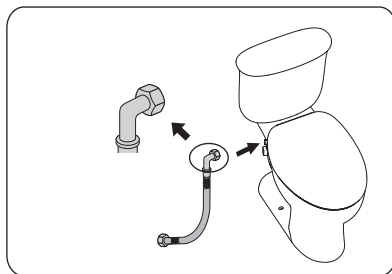
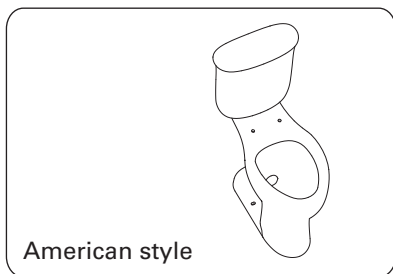

② When the toilet is similar to the figure above, we suggest connecting the elbow end of the hose to the cover

## 8. Connecting the flexible hose

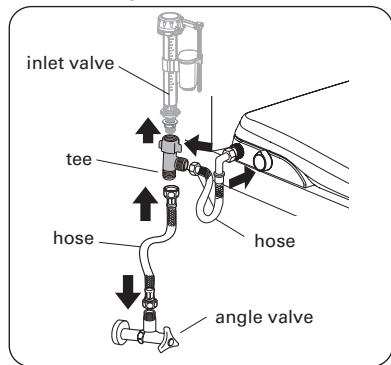

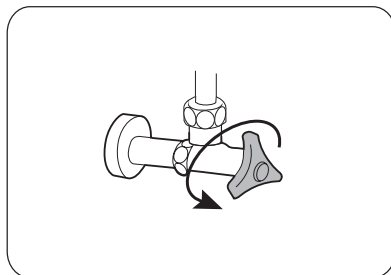

9. Open the valve to check for water leakage

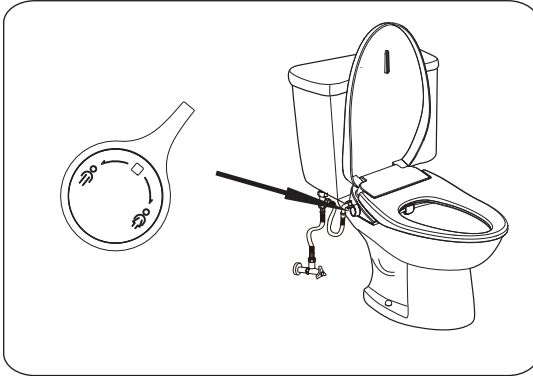

# Installation Instructions cont.

10. Turn on the bidet knob to check whether the nozzle is protruding;



**WARNING**  1. Do not remove internal elements of the bidet cover, otherwise mechanical failure will occur.  
2. Do not connect hot water above 100°F and cold water that may lead to icing.

## Product Operation

### ● Knob Function

#### 1. Rinse Function

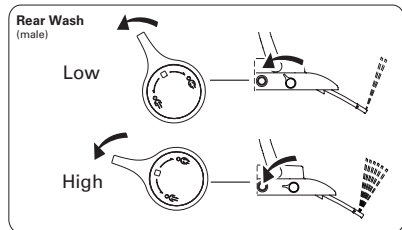
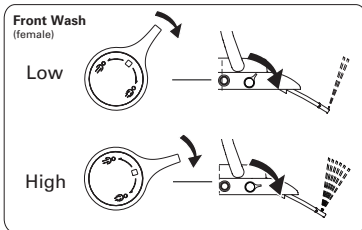

Rotate knob to adjust amount of water

**Note:** Open the knob to the maximum level and slowly adjust down to the desired amount of water and rinsing pressure before use.



# Product Technical Specification

Item		Description
Model		TB001-110
		TB002-110
Water supply pressure		0.1 ~ 0.75MPa
Water supply temperature		5 ~ 35°C
Ambient temperature		0 ~ 40°C
Net weight		About 2.2kg
Package dimensions		545×410×130mm
Cleaning device	Water amount regulation	Stepless regulation
	Anti-backflow device	Anti-siphon valve
Others	Antibacterial material	Wand and seat
	Control operation	Knob

## Troubleshooting

Phenomenon	Possible cause	Solution
Low flushing	Knob is not completely turned on.	Increase knob regulating angle.
	Water pressure is too low	You may need to contact a plumber to resolve
Turn on the knob and no water comes out	Valve is off	Open the valve
	The filter of the water inlet pipe is blocked	Clean the filter of the water inlet pipe
	Wand clogging	Remove the wand and clean
Spray rod cannot reset	Water quality is poor and blocking the spray rod	Clean spray rod
Base leaking	Water pressure is too high	You may need to contact a plumber to resolve

# Cleaning and Maintenance

## • Manual cleaning of spray tube

1. Gently pull out the wand.
2. Dip a soft sponge or small brush into a mild dish detergent.
3. Supporting the wand, gently wipe the spray tube and wand clean.

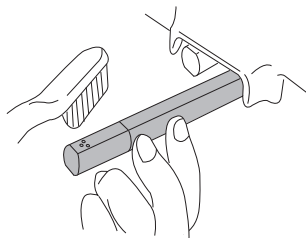

## • Clean filter screen

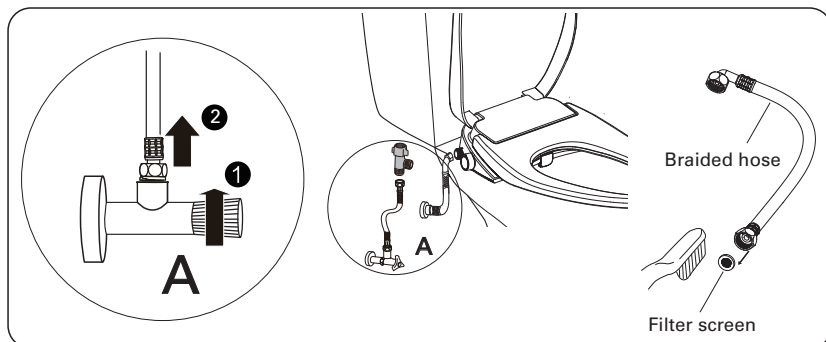

### **i** Tips:

1. Make sure that your stop valve is closed before you clean the filter screen.
2. Clean the filter screen.
3. During the cleaning process, product must be thoroughly separated from the water inlet hose.
4. Reinstall the filter screen in reverse order after cleaning.

## • Product surface cleaning

1. Wipe the product surface with a sponge or soft cloth dampened with room temperature water or a mild dish detergent.
2. Lift the cover and seat ring when cleaning.
3. Do not lower the cover or seat before the cleaning agent used on the ceramic toilet is completely washed, otherwise the surface may become corroded by the evaporating toilet bowl cleaner.



## LIMITED WARRANTY

### Bidet Toilet Seats

These products have been manufactured under the highest standards of quality and workmanship. That is why we are able to offer a limited 3-year guarantee on the function and finish of our products. Take a look at our warranty plan for more details.

#### Bidet Toilet Seats Function and Finish – Three Year Limited Warranty

The manufacturer warrants to the original consumer purchaser for as long as the original consumer purchaser owns their home (the “warranty period” for homeowners) that this product will be free from defects in materials and manufacturing workmanship for three years. The manufacturer recommends using a professional plumber for all installation and repair.

The manufacturer will provide, free of charge, at its sole option, replacement part(s) or product (or if no longer available, a comparable product) to replace, or make appropriate adjustment for, those which have proven defective in materials or workmanship under normal installation, use and service. This limited warranty does not cover, and the manufacturer is not liable for, labor charges incurred and/or damages sustained during the course of the installation, repair or replacement of any part(s) or product(s) provided under this limited warranty. In no event shall the liability of the manufacturer exceed the purchase price of the product. This limited warranty is non-transferable.

Proof of purchase (original sales receipt) from the original consumer purchaser must be made available to the manufacturer for all limited warranty claims

This warranty does not apply in the event of product damage due to the use of other than genuine 1858 Brands replacement parts, installation error, abuse, misuse, or improper care and maintenance (whether performed by a plumber, contractor, service provider or member of the purchaser’s household). This limited warranty excludes damage due to aggressive air or water conditions, or harsh or abrasive cleaners and/or materials\*. This limited warranty is applicable only to products installed in the United States and Canada.

THIS IS THE EXCLUSIVE WARRANTY BY THE MANUFACTURER WHICH IS IN LIEU OF ALL OTHER WARRANTIES, EXPRESS OR IMPLIED, INCLUDING BUT NOT LIMITED TO THE IMPLIED WARRANTIES OF MERCHANTABILITY AND FITNESS FOR A PARTICULAR PURPOSE. This warranty gives you specific legal rights, and you may also have other rights which vary from state/province to state/province. Some states/provinces do not allow the exclusion or limitation of incidental or consequential damages, so the above limitation or exclusion may not apply to you.

SELLER DISCLAIMS ANY LIABILITY FOR SPECIAL, INCIDENTAL, CONSEQUENTIAL, PUNITIVE OR EXEMPLARY DAMAGES. Some states/provinces do not allow limitations on how long an implied warranty lasts or the exclusion or limitation of such damages, so these limitations and exclusions may not apply to you. This warranty gives the consumer specific legal rights. You may also have other rights that vary from state/province to state/province.

If you have any questions or concerns regarding our warranty plan, please call 1-225-295-4212.

This limited warranty EXCLUDES all industrial, commercial and business usage, whose purchasers are hereby, extended a one-year limited warranty applying to all other terms of this limited warranty except duration.

\*Never use cleaners such as thinner, benzene, acidic chemicals, chloride, hydrochloric acid detergent, powdered detergents or nylon brush usage or other products not recommended for plastic. **This will void the warranty.**



*\*Effective July 1, 2023, due to an update in California law, the start date for product warranties will now be aligned with the date of delivery of the product. This change is for all Luxart products purchased on or after July 1, 2023 by California consumers. (California Legislative Information AB-2912)*